

River City Sportsplex Master Plan

August 2021





Master Plan Overall

Plan Elements

- 1 Maintenance facility shop and garage
- 2 Therapeutic Recreation fields
- 3 3,500-seat stadium
- 4 Adult fitness area / track
- 5 Destination playground
- 6 5k Trail
- 7 Picnic area / shelters / restroom
- 8 Multi-Purpose event building
- 9 Restroom with field viewing tower
- 10 Expanded field 9
- 11 Event parking
- 12 Shade structures and information kiosks

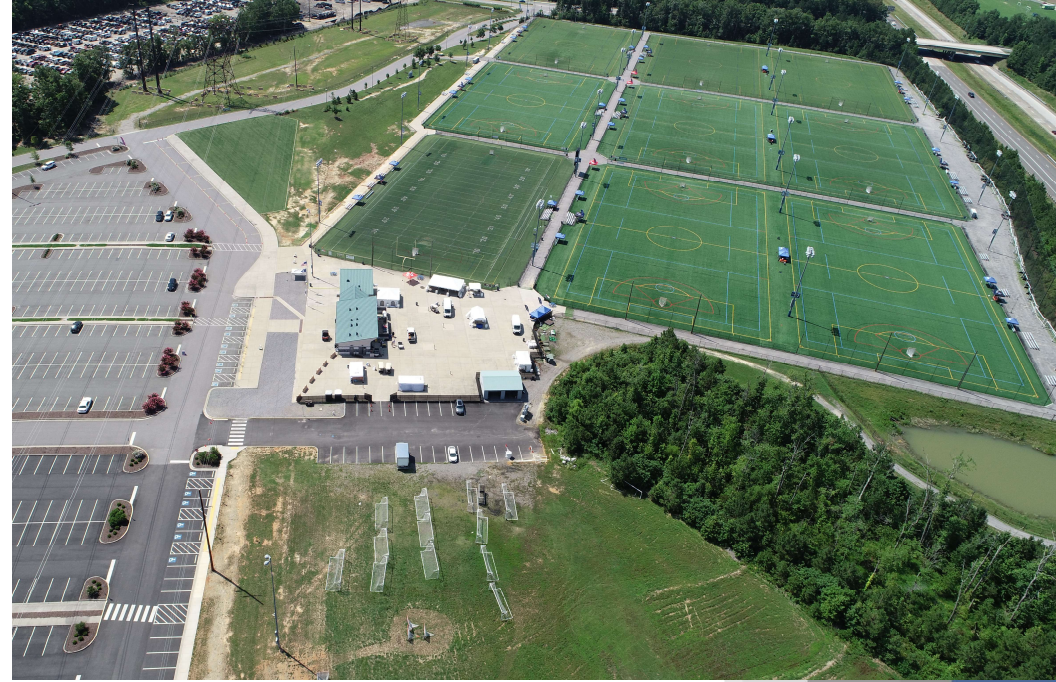

Existing Conditions & New Additions

 Proposed Additions

Existing Amenities:

- The front 9 fields will be upgraded as needed but will remain as top-tier competition fields.
- No decrease in parking capacity.
- No loss of wooded green space.
- Resource Protection Area (RPA) buffer will remain undisturbed.



Front 9 Athletic Area

- 1 Terraced hillside with tent and seating areas
- 2 Expand field nine to full soccer size (while retaining football capacity)
- 3 Tree plantings for shade and screening
- 4 Restroom with field viewing platform
- 5 Information kiosk
- 6 Turf overflow event parking
- 7 Shade structures
- 8 Thin understory vegetation and remove invasive species to enhance views from Veterans Memorial Highway.

Restroom with viewing platform, and shade structure



Terraced Hillside and Seating

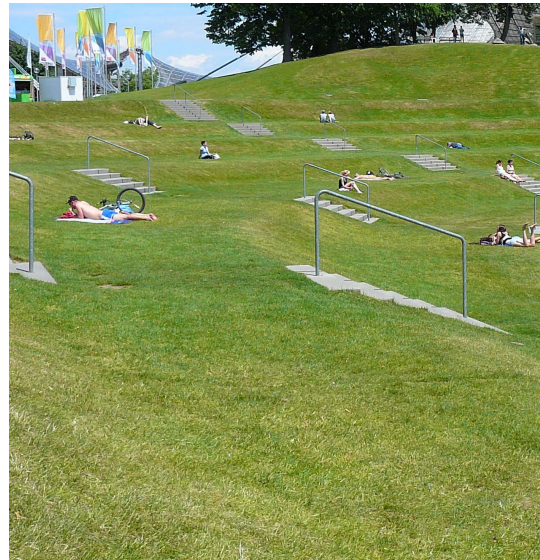

Overflow Event Parking





Back 7 Athletic Area

- 1 Therapeutic Recreation (fully accessible) fields
- 2 New 3,500-seat stadium
- 3 Shade structures
- 4 District Offices & shop
- 5 Warm up area & equipment storage area
- 6 New regulation fields

Maintenance Shop & Garage



Warm Up Field and Equipment Storage

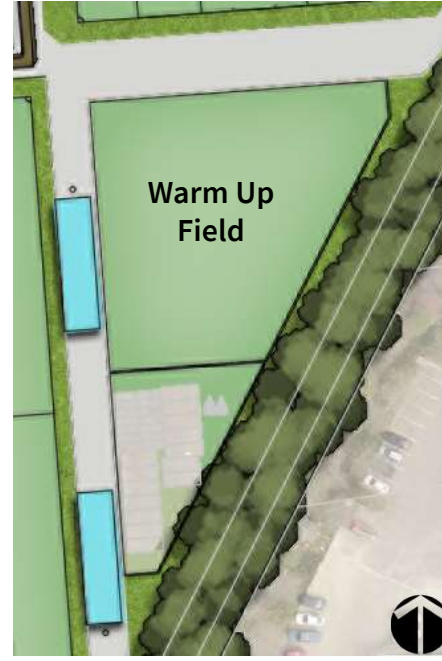

Therapeutic Recreation (Fully Accessible) Fields





3,500-Seat Multi-Sport / Event Stadium



Field 10 Multi-Sport/Event Stadium

Sportsplex Core

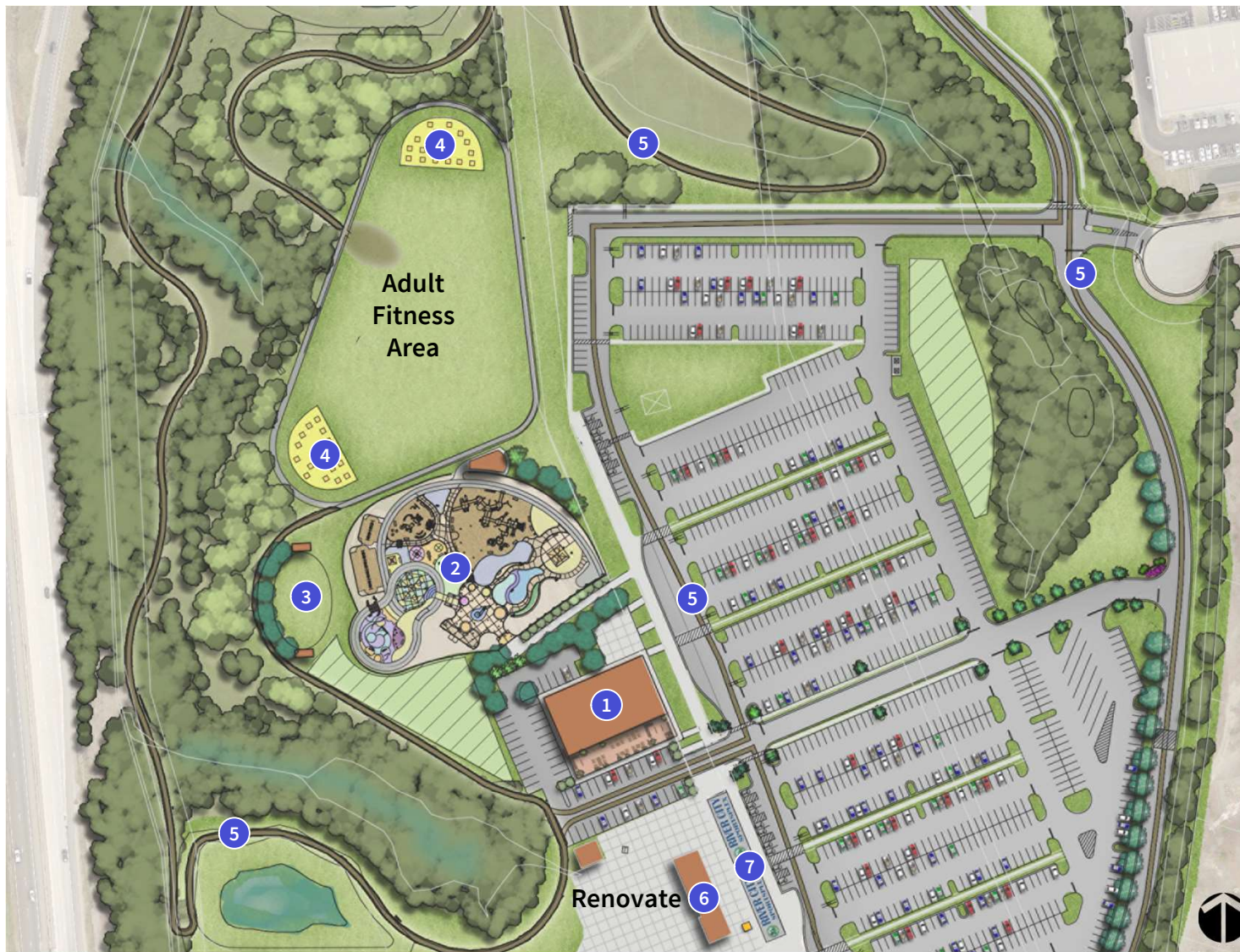

- 1 15,000 SF multi-purpose building with rooftop observation area and restaurant. This building will include parking, a service area, and entry plaza.
- 2 58,000 SF Destination playground with water play and universally accessible elements
- 3 Open-play picnicking area
- 4 Adult fitness stations and 1/4- mile flat track
- 5 5K running Trail (2.5k rustic trail, 2.5k on road trail)
- 6 Renovations to existing restroom and concessions building to include larger locker rooms, larger concession area, and less office space.
- 7 Replace gravel areas with logo printed artificial turf

Destination Playground



Adult Fitness and flat track

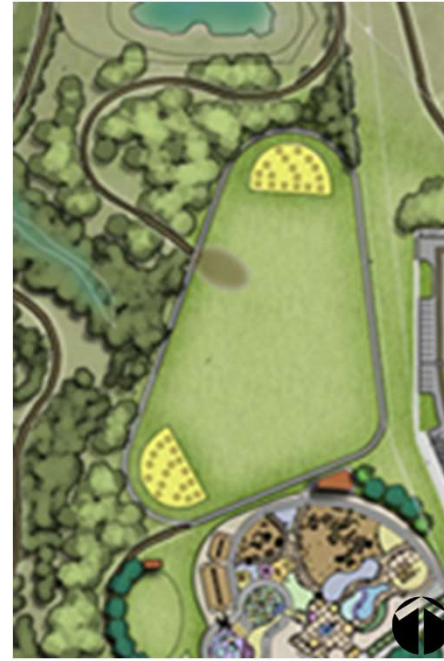

Picnic Area with Shelters



Event Building and Rooftop Restaurant



5k Running path



Renovated Building and logo turf



Description of Changes

- Larger locker rooms
- Larger Concession and ticketing area
- Remove offices
- Reduce storage areas

